

Coleman Creek Consulting, Inc.

DRINKING WATER LEAD SAMPLING
OF
KLAMATH FALLS ESD FACILITY
2685 FOOTHILLS BLVD, KLAMATH FALLS, OREGON
FOR
SOUTHERN OREGON EDUCATION SERVICE DISTRICT

INTRODUCTION

Coleman Creek Consulting, Inc. (CCC) was retained by the Southern Oregon Education Service District (SOESD) to perform representative lead and copper drinking water sampling of the Klamath Falls ESD Facility at the above address. The purpose of the lead and copper drinking water sampling was to determine the concentration of lead and copper in representative drinking water sources and compare with regulatory standards. In 2017, Education Service Districts were required to adopt a Healthy and Safe Schools Plan, including provisions for testing and reducing exposure to elevated levels of lead in water used for drinking and food preparation.

LEAD DRINKING WATER SAMPLING REQUIREMENTS

Guidelines for sampling lead in water were established by the Oregon Health Authority. Water sampling is to occur after water sits overnight in the pipes without being used, and must be sampled after a day occupied by students or building occupants. All water sources are to be sampled, with the exception of water used for heating, sanitation, irrigation, and science sinks for grades 6 and up with non-potable water signs. Initial testing is required to be performed by 2020, and every 6 years thereafter, according to a testing schedule determined by the Oregon Department of Education.

DRINKING WATER SAMPLING

David W. Fawcett of CCC visited the Klamath Falls ESD Facility on October 24, 2019. Mr. Fawcett collected a lead and copper drinking water sample from the drinking water sources identified in the facility. See Site Sample Record Sheet (page 3) for a description of the drinking water sources sampled. See Drinking Water Sample Location Diagram in Appendix A for a visual review of all drinking water sample locations. The drinking water samples were collected in the early morning, ensuring that the sample source had not been in use since the previous day. The sample was placed in a cooler and transported to Neilson Research Corporation for lead analysis.

DRINKING WATER LEAD RESULTS AND TESTING SUMMARY SHEET

The five drinking water samples collected were analyzed for lead using EPA Method 200.8. See Neilson Research Corporation Analytical Report in Appendix B. A Drinking Water Testing Summary Sheet (page 4) indicates the lead in drinking water concentrations for the five water samples were reported ranging from 0.414 to 1.4 parts per billion (ppb).

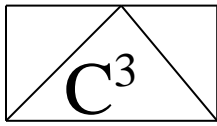

Coleman Creek Consulting, Inc.

CONCLUSIONS

Five drinking water samples were collected from drinking water sources at the Klamath Falls ESD Facility prior to use that day by building occupants, and after a day the facility was occupied. The lead concentrations reported were all below the 15 ppb lead action level in water.

RECOMMENDATIONS

Coleman Creek Consulting, Inc. recommends future drinking water sampling at the Klamath Falls ESD Facility according to the schedule set out by the Oregon Department of Education. Coleman Creek Consulting, Inc. appreciates the opportunity to continue to perform environmental sampling and consulting services to Southern Oregon Education Service District.

David W. Fawcett
Director of Consulting Services

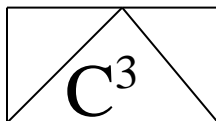

Coleman Creek Consulting, Inc.

DRINKING WATER LEAD/COPPER SAMPLE RECORD SHEET

FACILITY: Klamath Falls ESD Facility
ADDRESS: 2685 Foothills Blvd.
Klamath Falls, Oregon

DATE: 10-24-19
SAMPLER: David W. Fawcett

SAMPLE #	SOURCE DESCRIPTION	LOCATION	COLLECTION TIME
19-104G.K1	Drinking Fountain	Hall Drinking Fountain	0721
19-104G.K2	Sink Faucet	Break Room Sink	0723
19-104G.K3	Sink Faucet	Women's Restroom Sink	0725
19-104G.K4	Sink Faucet	Men's Restroom Sink	0727
19-104G.K5	Sink Faucet	Mechanical Room Sink	0729

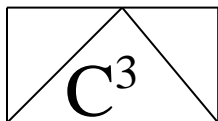

Coleman Creek Consulting, Inc.

DRINKING WATER TESTING SUMMARY SHEET

DISTRICT NAME: Southern Oregon Education Service District
DISTRICT ID#: 2025
SCHOOL NAME: Klamath Falls Office
BUILDING NAME: Klamath Falls Office Building
BUILDING ID#: 20250010

Sample Number	Fixture Location Description	Fixture ID#	Test Date	Test Result (ppb)	# Retest	Final Result (ppb)
19-104G.K1	Hall Drinking Fountain	DW	10-24-19	0.806		
19-104G.K2	Breakroom Sink	KF	10-24-19	1.4		
19-104G.K3	Women's RR Sink	BF	10-24-19	0.414		
19-104G.K4	Men's RR Sink	BF	10-24-19	0.774		
19-104G.K5	Mechanical Room Sink	OT	10-24-19	0.455		

Fixture ID Coding:

DW = Drinking Water Fountain WC = Water Cooler WB = Water Bottle Filler
CF = Classroom Faucet BF = Bathroom Faucet SF = Staff/Office Faucet
KF = Kitchen/Food Prep OS = Outside Spigot OT = Other (Specify)

APPENDIX A

**DRINKING WATER SAMPLE LOCATION
DIAGRAM**

DRINKING WATER SAMPLE LOCATION DIAGRAM
Klamath Office - 2685 Foothills Blvd., Klamath Falls

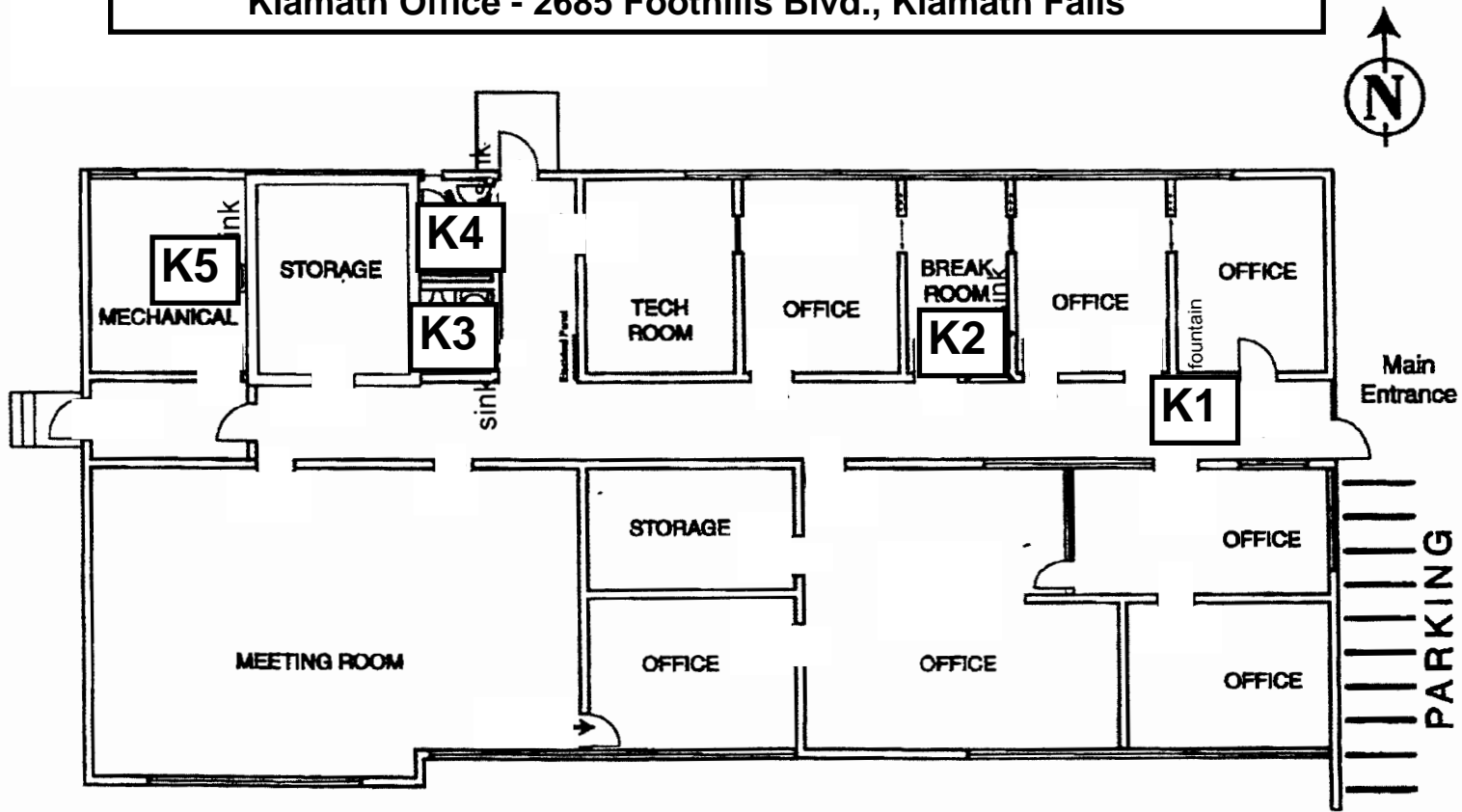

LEGEND:

[K2] = Drinking Water Sample Location

APPENDIX B

**NEILSON RESEARCH CORPORATION
ANALYTICAL REPORT**



Neilson Research Corporation
245 S Grape St
Medford, OR 97501
TEL: (541) 770-5678 FAX: (541) 770-2901
Website: www.nrclabs.com

October 30, 2019

Dave Fawcett
Coleman Creek Consulting
810 Leonard St
Ashland, OR 97520
TEL: (541) 535-7108
FAX: (541) 535-8795

RE: 19-104G SOESD-Klamath

Order No.: 19101072

Dear Dave Fawcett:

Neilson Research Corporation received 5 sample(s) on 10/24/2019 for the analyses presented in the following report.

The results relate only to the parameters tested or to the sample as received by the laboratory. This report shall not be reproduced except in full, without the written approval of Neilson Research Corporation. If you have any questions regarding these test results, please feel free to call.

Sincerely,
Neilson Research Corporation

Tamra Schmedemann
Senior Project Manager
245 S Grape St
Medford, OR 97501

Original



Neilson Research Corporation
245 S Grape St
Medford, OR 97501
TEL: (541) 770-5678 FAX: (541) 770-2901
Website: www.nrclabs.com

Case Narrative

WO#: 19101072
Date: 10/30/2019

CLIENT: Coleman Creek Consulting

Project: 19-104G SOESD-Klamath

The analyses were performed according to the guidelines in the Neilson Research Corporation Quality Assurance Program. This report contains analytical results for the sample(s) as received by the laboratory.

Neilson Research Corporation certifies that this report is in compliance with the requirements of NELAP. No unusual difficulties were experienced during analysis of this batch except as noted below or qualified with data flags on the reports.

Original



Neilson Research Corporation
 245 S Grape St
 Medford, OR 97501
 TEL: (541) 770-5678 FAX: (541) 770-2901
 Website: www.nrclabs.com

Analytical Report

WO#: 19101072
 Date Reported: 10/30/2019

Coleman Creek Consulting
 810 Leonard St
 Ashland, OR 97520

Lab Order: 19101072
Received Date: 10/24/2019 9:19:00 AM
Reported Date: 10/30/2019 1:52:22 PM

Sample Information:

Lab ID: 19101072-01 Client Sample ID: 19-104G.K1
 Collection Date: 10/24/2019 7:21:00 AM Collected By: David Fawcett
 Matrix: Drinking Water Sample Location: Grab

Trace Metals by EPA 200.8 ICP-MS								Analyst: SJS
Analyses	Result	Qual	MRL	Units	DF	Date Analyzed	MCL	NELAP Status
Copper	10.9		0.515	µg/L	1	10/28/2019	1300	A
Lead	0.806		0.103	µg/L	1	10/25/2019	15.0	A

Lab ID: 19101072-02 Client Sample ID: 19-104G.K2
 Collection Date: 10/24/2019 7:23:00 AM Collected By: David Fawcett
 Matrix: Drinking Water Sample Location: Grab

Trace Metals by EPA 200.8 ICP-MS								Analyst: SJS
Analyses	Result	Qual	MRL	Units	DF	Date Analyzed	MCL	NELAP Status
Copper	1.61		0.515	µg/L	1	10/28/2019	1300	A
Lead	1.40		0.103	µg/L	1	10/25/2019	15.0	A

Lab ID: 19101072-03 Client Sample ID: 19-104G.K3
 Collection Date: 10/24/2019 7:25:00 AM Collected By: David Fawcett
 Matrix: Drinking Water Sample Location: Grab

Trace Metals by EPA 200.8 ICP-MS								Analyst: SJS
Analyses	Result	Qual	MRL	Units	DF	Date Analyzed	MCL	NELAP Status
Copper	2.12		0.515	µg/L	1	10/28/2019	1300	A
Lead	0.414		0.103	µg/L	1	10/25/2019	15.0	A

- | | | |
|-------------------|--|--|
| QUALIFIERS | * Value exceeds Maximum Contaminant Level. | C1 Sample container temperature is out of limit as specified at testcode |
| | E Value above quantitation range | H Holding times for preparation or analysis exceeded |
| | J Analyte detected below quantitation limits | MI Recovery outside control limits due to Matrix Interference |
| | ND Not Detected at the Reporting Limit | PL Permit Limit |
| | R RPD outside accepted recovery limits | |

Original



Neilson Research Corporation
 245 S Grape St
 Medford, OR 97501
 TEL: (541) 770-5678 FAX: (541) 770-2901
 Website: www.nrclabs.com

Analytical Report

WO#: 19101072
 Date Reported: 10/30/2019

Coleman Creek Consulting
 810 Leonard St
 Ashland, OR 97520

Lab Order: 19101072
Received Date: 10/24/2019 9:19:00 AM
Reported Date: 10/30/2019 1:52:22 PM

Sample Information:

Lab ID: 19101072-04 Client Sample ID: 19-104G.K4
 Collection Date: 10/24/2019 7:27:00 AM Collected By: David Fawcett
 Matrix: Drinking Water Sample Location: Grab

Trace Metals by EPA 200.8 ICP-MS								Analyst:	SJS
Analyses	Result	Qual	MRL	Units	DF	Date Analyzed	MCL	NELAP Status	
Copper	1.39		0.515	µg/L	1	10/28/2019	1300	A	
Lead	0.774		0.103	µg/L	1	10/25/2019	15.0	A	

Lab ID: 19101072-05 Client Sample ID: 19-104G.K5
 Collection Date: 10/24/2019 7:29:00 AM Collected By: David Fawcett
 Matrix: Drinking Water Sample Location: Grab

Trace Metals by EPA 200.8 ICP-MS								Analyst:	SJS
Analyses	Result	Qual	MRL	Units	DF	Date Analyzed	MCL	NELAP Status	
Copper	1.23		0.515	µg/L	1	10/28/2019	1300	A	
Lead	0.455		0.103	µg/L	1	10/25/2019	15.0	A	

QUALIFIERS	* Value exceeds Maximum Contaminant Level.	C1 Sample container temperature is out of limit as specified at testcode
	E Value above quantitation range	H Holding times for preparation or analysis exceeded
	J Analyte detected below quantitation limits	MI Recovery outside control limits due to Matrix Interference
	ND Not Detected at the Reporting Limit	PL Permit Limit
	R RPD outside accepted recovery limits	

Original



Neilson Research Corporation
 245 S Grape St
 Medford, OR 97501
 TEL: (541) 770-5678 FAX: (541) 770-2901
 Website: www.nrclabs.com

QC SUMMARY REPORT

WO#: 19101072
 30-Oct-19

Client: Coleman Creek Consulting
Project: 19-104G SOESD-Klamath

TestCode: ICPMS_200.8_DW

Sample ID: MB-2216	SampType: MBLK	TestCode: ICPMS_200.8	Units: µg/L	Prep Date: 10/25/2019	RunNo: 5174						
Client ID: PBW	Batch ID: 2216	TestNo: E200.8	E200.8	Analysis Date: 10/25/2019	SeqNo: 99194						
Analyte	Result	PQL	SPK value	SPK Ref Val	%REC	LowLimit	HighLimit	RPD Ref Val	%RPD	RPDLimit	Qual

Copper	ND	0.515									
Lead	ND	0.103									

Sample ID: LCS-2216	SampType: LCS	TestCode: ICPMS_200.8	Units: µg/L	Prep Date: 10/25/2019	RunNo: 5174						
Client ID: LCSW	Batch ID: 2216	TestNo: E200.8	E200.8	Analysis Date: 10/25/2019	SeqNo: 99195						
Analyte	Result	PQL	SPK value	SPK Ref Val	%REC	LowLimit	HighLimit	RPD Ref Val	%RPD	RPDLimit	Qual

Lead	115	0.104	100	0	115	85	115				
------	-----	-------	-----	---	-----	----	-----	--	--	--	--

Sample ID: 19101089-12AMS	SampType: MS	TestCode: ICPMS_200.8	Units: µg/L	Prep Date: 10/25/2019	RunNo: 5174						
Client ID: BatchQC	Batch ID: 2216	TestNo: E200.8	E200.8	Analysis Date: 10/25/2019	SeqNo: 99207						
Analyte	Result	PQL	SPK value	SPK Ref Val	%REC	LowLimit	HighLimit	RPD Ref Val	%RPD	RPDLimit	Qual

Copper	515	0.520	100	425	89.8	70	130				
Lead	114	0.104	100	3.63	110	70	130				

Sample ID: 19101089-12AMSD	SampType: MSD	TestCode: ICPMS_200.8	Units: µg/L	Prep Date: 10/25/2019	RunNo: 5174						
Client ID: BatchQC	Batch ID: 2216	TestNo: E200.8	E200.8	Analysis Date: 10/25/2019	SeqNo: 99208						
Analyte	Result	PQL	SPK value	SPK Ref Val	%REC	LowLimit	HighLimit	RPD Ref Val	%RPD	RPDLimit	Qual

Copper	511	0.520	100	425	85.4	70	130	515	0.845	20	
Lead	114	0.104	100	3.63	111	70	130	114	0.723	20	

Qualifiers: C1 Sample container temperature is out of limit as specified at testcode H Holding times for preparation or analysis exceeded MI Recovery outside control limits due to Matrix In
 ND Not Detected at the Reporting Limit PL Permit Limit RL Reporting Detection Limit

Original

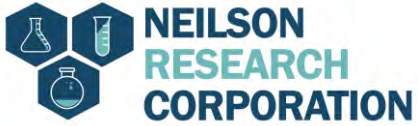

Neilson Research Corporation
 245 S Grape St
 Medford, OR 97501
 TEL: (541) 770-5678 FAX: (541) 770-2901
 Website: www.nrclabs.com

QC SUMMARY REPORT

WO#: 19101072
 30-Oct-19

Client: Coleman Creek Consulting
Project: 19-104G SOESD-Klamath

TestCode: ICPMS_200.8_DW

Sample ID: 19101089-12AMSD	SampType: MSD	TestCode: ICPMS_200.8	Units: µg/L	Prep Date: 10/25/2019	RunNo: 5174						
Client ID: BatchQC	Batch ID: 2216	TestNo: E200.8	E200.8	Analysis Date: 10/25/2019	SeqNo: 99208						
Analyte	Result	PQL	SPK value	SPK Ref Val	%REC	LowLimit	HighLimit	RPD Ref Val	%RPD	RPDLimit	Qual

Sample ID: LCS-2216	SampType: LCS	TestCode: ICPMS_200.8	Units: µg/L	Prep Date: 10/25/2019	RunNo: 5203						
Client ID: LCSW	Batch ID: 2216	TestNo: E200.8	E200.8	Analysis Date: 10/28/2019	SeqNo: 99692						
Analyte	Result	PQL	SPK value	SPK Ref Val	%REC	LowLimit	HighLimit	RPD Ref Val	%RPD	RPDLimit	Qual
Copper	105	0.520	100	0	105	85	115				

Qualifiers: C1 Sample container temperature is out of limit as specified at testcode H Holding times for preparation or analysis exceeded MI Recovery outside control limits due to Matrix In
 ND Not Detected at the Reporting Limit PL Permit Limit RL Reporting Detection Limit

Original

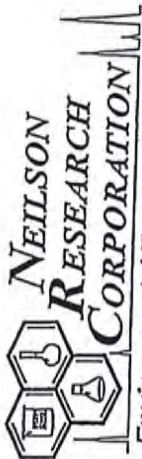

Environmental Testing Laboratory
 245 South Grape Street * Medford, OR 97501
 (541) 770-5678 fax (541) 770-2901

Chain of Custody Record

This Chain of Custody is a LEGAL DOCUMENT and must be filled out accurately.

Section A
 Required Client Information
 Company: Coleman Creek Consulting
 Address: 810 Leonard St
 Ashland, OR 97520
 Email: fawbro@ccountry.net
 Phone: (541) 535-7108 Fax: (541) 535-8795
 Collected By (Print): David W. Fawcett
 Collected By (Sign): *[Signature]*
 Email Report Yes No Mail Report Yes No
 Fax Report Yes No

Section B
 Required Project Information
 Project Name: SOESP - Klamath
 Project Number: 19-1046
 Report To: Dave Fawcett
 Copy To:

Section C
 Invoice Information
 Attention:
 Company Name:
 Address:
 P.O. #

Section D
 Rush Status (Subject to Scheduling)
 Standard 10-14 Days
 5 Business Days (50% surcharge)
 3 Business Days (75% surcharge)
 24 - 48 hours (100% surcharge)
 Other

Section E
 Authorized Yes No

Sample ID	Comp/Grab	Matrix*	Date Collected	Time Collected	No. of Containers	Analysis Requested	Remarks/Field Data	NRC Sample # (Lab Use Only)
19-1046-K1	Grab	DW	10-24-19	0721	1			011A
K2				0723	1			021A
K3				0725	1			031A
K4				0727	1			041A
K5				0729	1			051A

*Matrix: DW - Drinking Water WW - Wastewater W - Water S - Soil/Solid SL - Sludge O - Oil WP - Wipe OT - Other

Section F
 Relinquish/Receive
 Relinquished By: *[Signature]* Sign
 Received By: David W. Fawcett Print
 Date: 10-24-19 Time: 0919
 Relinquished By:
 Received By: *[Signature]*
 Relinquished By:
 Received By Laboratory: *[Signature]*

Section G
 Lab Use Only
 Temp: 5
 4°C +/- 2°C: Yes No
 Received on Ice: Yes No
 Number of Bottles Received: 5
 pH Checked: Yes No
 GOC Seals Intact: Yes No
 Field Blank Included: Yes No
 UPS: FedEX: Other: Hand
 Payment: Invoice Cash: VISA, M/C: Check #: